

No. 373 / TR5®

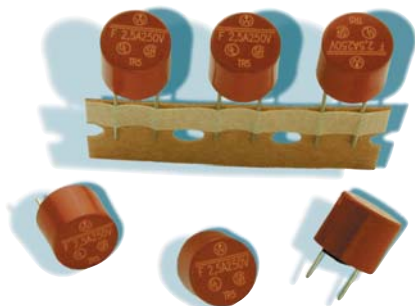

Dimensions (mm)

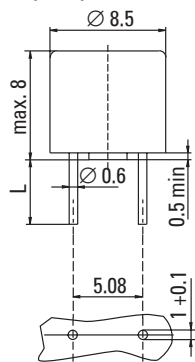

Holes in PCB
 Long Leads (L=18.8 mm)
 Short Leads (L=4.3 mm)

UL 248-14, 250 V, F lead free

Time-Current Characteristic
 Quick Acting (F)

Standard
 UL 248-14
 CSA C22.2 No. 248.14

Approvals
 UL Listed
 CSA Certified

Features

- Reduced PCB space requirements
- Direct solderable or plug-in versions
- Internationally approved
- Low internal resistance
- Shocksafe casing
- Vibration resistant
- Halogen free

Specifications

Packaging
 000: Tape/Ampopack (1,000 pcs.)
 041: Short Leads - Bulk (1,000 pcs.)

Materials
 Base/Cap: Brown Thermoplastic
 Polyamide PA 6.6, UL 94V0
 Round Pins: Copper, Sn plated

Operating Temperature
 -40 °C to +85 °C (consider de-rating)

Climatic Category
 -40 °C/+85 °C/21 days (EN 60068-1,-2-1,-2-2,-2-78)

Stock Conditions
 +10 °C to +60 °C
 relative humidity ≤ 75 % yearly average,
 without dew, maximum value for 30 days-95 %

Vibration Resistance
 24 cycles at 15 min. each (EN 60068-2-6)
 10 - 60 Hz at 0.75 mm amplitude
 60 - 2000 Hz at 10 g acceleration

Lead Pull Strength
 10 N (EN 60068-2-21)

Solderability
 260 °C, ≤ 3 s (Wave)
 350 °C, ≤ 3 s (Soldering iron)

Soldering Heat Resistance
 260 °C, 10 s (IEC 60068-2-20)

Marking
 Ⓢ, 373, 250 V, F, Current Rating, Approvals

Unit Weight
 0.77 g (approx.)



Limits for Pre-arcing Time

| | |
|-------------------|------------------------|
| Rated Current | 2.0 x I _N Ⓢ |
| 50 mA ... 6.30 A | < 5 s |
| 8.00 A ... 10.00A | < 60 s |

Permissible continuous operating current is ≤ 70 % at ambient temperature of 23 °C (73.4 °F).

| Rated Current | Amp Code | Voltage Rating | Breaking Capacity | Voltage Drop 1.0 x I _N Ⓢ max. (mV) | Power Dissipation 1.0 x I _N Ⓢ max. (mW) | Melting Integral 10 x I _N Ⓢ max. (A ² s) | Approvals UL CSA cULus |
|---------------------|----------|----------------|--------------------------------------|---|--|--|---------------------------|
| 50mA | 0050 | 250V | | 1400 | 70 | 0.0001 | • • |
| 63mA | 0063 | 250V | | 1300 | 85 | 0.00023 | • • |
| 80mA | 0080 | 250V | | 1200 | 100 | 0.00037 | • • |
| 100mA | 0100 | 250V | | 1100 | 110 | 0.0013 | • • |
| 125mA | 0125 | 250V | | 1000 | 125 | 0.0019 | • • |
| 160mA | 0160 | 250V | | 950 | 155 | 0.004 | • • |
| 200mA | 0200 | 250V | | 850 | 170 | 0.0065 | • • |
| 250mA | 0250 | 250V | | 750 | 190 | 0.014 | • • |
| 315mA | 0315 | 250V | | 650 | 205 | 0.032 | • • |
| 400mA | 0400 | 250V | 50A/250V AC 50-60 Hz cos φ=1.0 | 230 | 95 | 0.016 | • • |
| 500mA | 0500 | 250V | | 220 | 110 | 0.025 | • • |
| 630mA | 0630 | 250V | | 210 | 135 | 0.045 | • • |
| 800mA | 0800 | 250V | | 200 | 160 | 0.069 | • • |
| 1.00A | 1100 | 250V | | 190 | 190 | 0.125 | • • |
| 1.25A | 1125 | 250V | | 180 | 225 | 0.2 | • • |
| 1.60A | 1160 | 250V | | 170 | 275 | 0.38 | • • |
| 2.00A | 1200 | 250V | | 160 | 320 | 0.63 | • • |
| 2.50A | 1250 | 250V | | 150 | 375 | 1.2 | • • |
| 3.15A | 1315 | 250V | | 140 | 445 | 1.9 | • • |
| 4.00A | 1400 | 250V | | 130 | 520 | 3.5 | • • |
| 5.00A | 1500 | 250V | | 120 | 630 | 6.2 | • • |
| 6.30A | 1630 | 250V | | 115 | 1000 | 9.1 | • • |
| 8.00A ¹ | 1800 | 250V | | 120 | 1600 | 30 | • • |
| 10.00A ¹ | 2100 | 250V | | 110 | 2000 | 55 | • • |

¹ Conducting path cross-section minimum ≥ 0.2mm²
 Note: 1.00 means the number one with two decimal places. 1,000 means the number one thousand.

Order Information

| Qty. | Order-Number | Series | Amp Code | Packaging |
|------|--------------|--------|----------|-----------|
| | | 373 | | |

Specifications are subject to change without notice

TR5[®] / No. 373

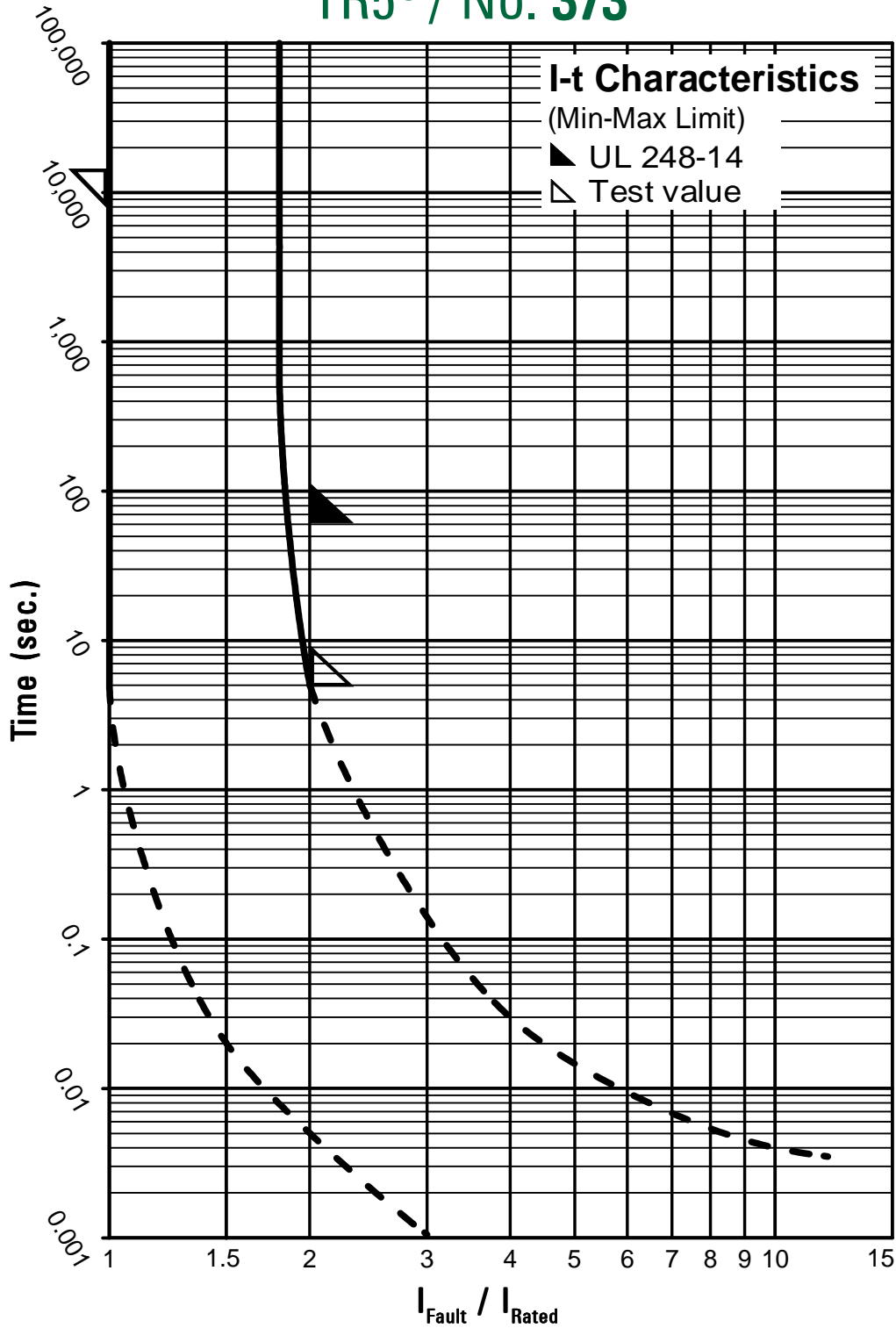

Contact Littelfuse for individual I-t curves